

FOR LEASE Self-Storage 5007 Elm Lubbock, TX

Gordon Wilkerson
806-474-2207 (office)
806-441-4307 (mobile)
806-474-2216 (fax)



Unit 11:

- 336 s.f.
- \$125/month

Unit 14:

- 374 s.f.
- \$125/month

Unit 15:

- 1912 s.f.
- \$575/month

Features:

- Interior access
- Security system
- Built-in shelving
- Concrete and steel construction
- Dust controlled
- Dock high and ramp access

Commercial & Industrial Construction, Development, Management & Brokerage

Gordon Wilkerson
Mobile: 806-441-4307
Home: 806-794-7640
gwilk@wilkersonstorage.com

David Wilkerson
Mobile: 806-441-2200
Home: 806-785-2087
davewilk@wilkersonproperties.com

www.wilkersonproperties.com

Any information given herewith is obtained from sources we consider reliable. However, we are not responsible for misstatement of facts, errors, omissions, prior sale, withdrawal from market, modification of mortgage commitment, terms and conditions or change in price without notice. The information supplied herein is for informational purposes only and shall not constitute a warranty or assurance that said information is correct. Any person intending to rely upon the information supplied herein should verify said information independently.

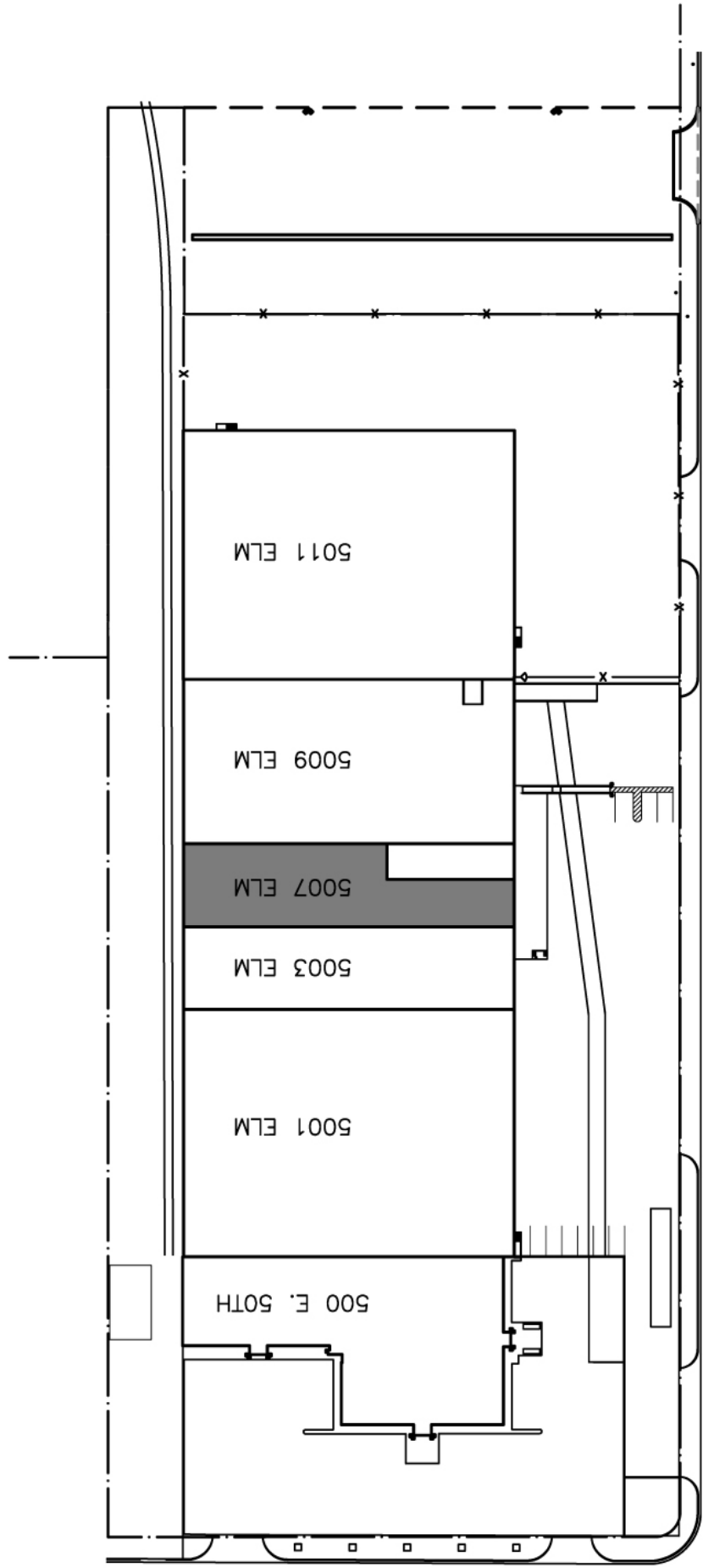

ELM AVENUE

 **SITE PLAN**
SCALE: 1" = 100'

50th STREET

 <p>Wilkerson PROPERTIES INC.</p>	Commercial & Industrial Development, Management & Brokerage Phone: (806) 474-2223 Fax: (806) 474-2216 501 E. 66th Street Lubbock, Texas 79404		Date: 06/27/2008	Rev:
	5001-5011 Elm Avenue Lubbock, Texas 79404		Drawn by: JWT	Checked by:
G:\500 E 50th\500e50th-s.dwg, WEB, 6/27/2008 1:48:47 PM				

C1

5003 WAREHOUSE

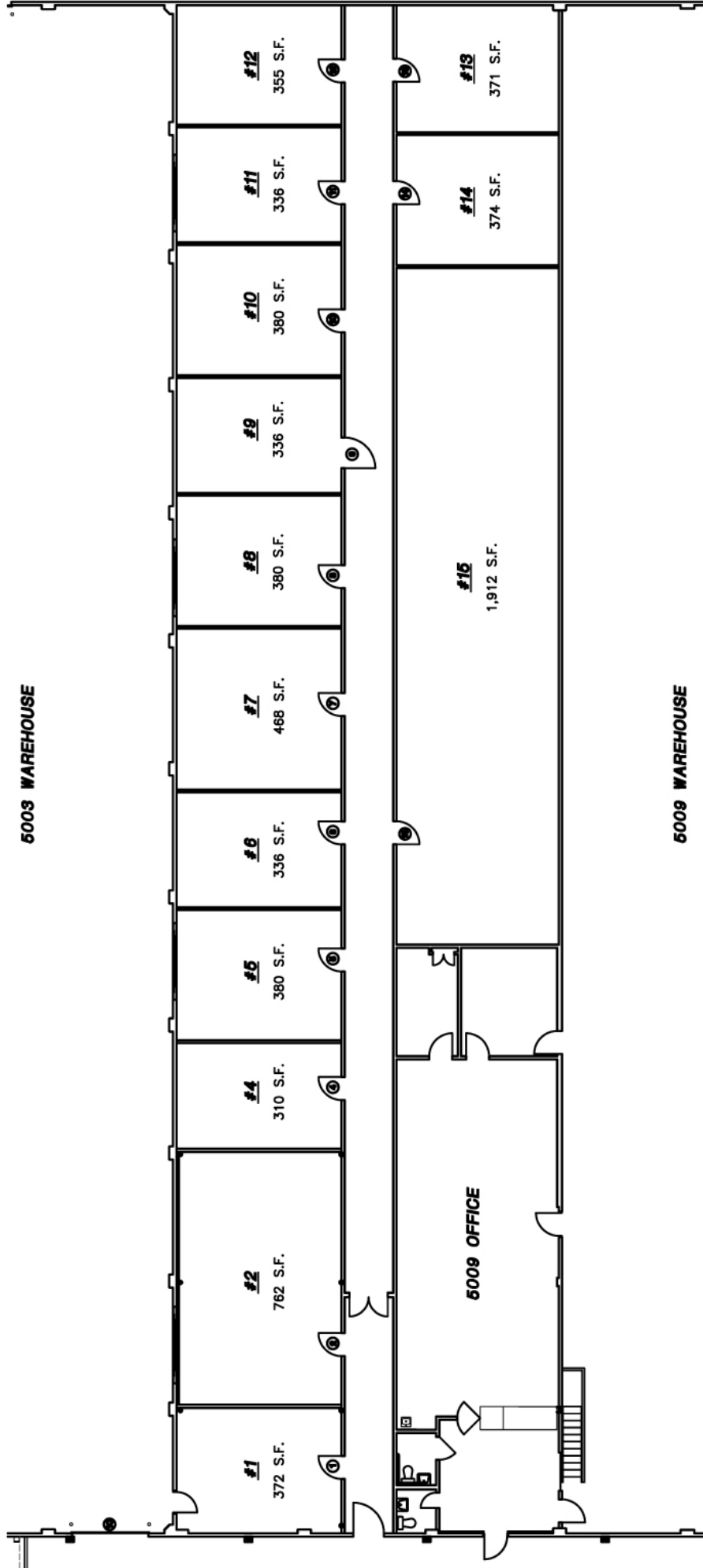

5009 WAREHOUSE

EXIST. FLOOR PLAN

SCALE: 1" = 20'



<h1 style="margin: 0;">Wilkerson</h1> <p style="margin: 0;">PROPERTIES INC.</p>	Commercial & Industrial Development, Management & Brokerage Phone: (806) 474-2223 Fax: (806) 474-2216 501 E. 66th Street Lubbock, Texas 79404		STORAGE UNITS 5007 Elm Avenue Lubbock, Texas 79404	Date: 06/27/2008 Drawn by: JWT Checked by:	Rev:
	A1				
	G:\500 E 50th\500e50th-f.dwg, 5007 - 85x11, 6/27/2008 2:03:37 PM				